





20 Wycombe Street Epping NSW

5  2  2 

Positioned in one of Epping's most tightly held and family-oriented streets, this beautifully renovated residence at 20 Wycombe Street offers an exceptional blend of modern comfort and everyday convenience. Located just approx. 200m from Epping Heights Public School and within easy walking distance to Cheltenham Station and Epping Station, it provides an outstanding lifestyle opportunity for families seeking quality education and connectivity.

Recently transformed with a sophisticated contemporary vision, the home reveals light-filled interiors enhanced by quality finishes, clean architectural lines, and a cohesive modern palette. Set on a generous 705sqm (approx.) level parcel with a wide frontage, this immaculate single-level

Type : House
Price : Auction
Land Size : 705 sqm
View : <https://www.uniland.com.au/sale/nsw/northern-suburbs/epping/residential/house/8683890>



Andy Lin
02 9869 7788



Karen Ge
02 9869 7788

[For full version visit the website](https://www.uniland.com.au)



0 1 2 3 4 5m

Scale in metres. Indicative only. Dimensions are approximate.

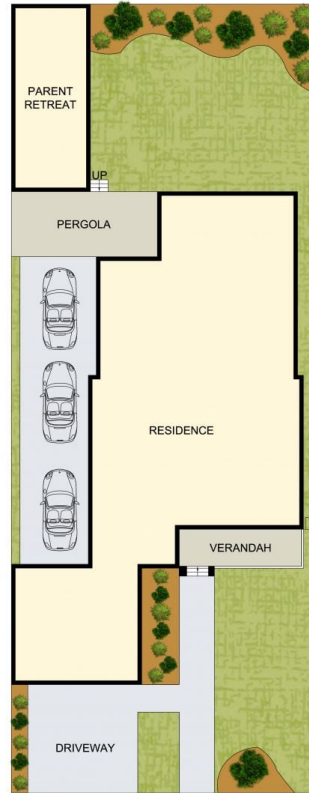

SITE PLAN (NOT TO SCALE)



DISCLAIMER: PLANS SHOWN ARE FOR MARKETING PURPOSES ONLY, ALL DIMENSIONS ARE APPROXIMATE AND NOT TO SCALE. THEY ARE SUBJECT TO ERRORS AND INACCURACIES AND NO LIABILITY WILL BE ACCEPTED. INTERESTED PARTIES SHOULD MAKE THEIR OWN INQUIRES.

20 Wycombe Street, Epping

