



30A Francis Street Epping NSW

5  4  2 

Nestled in one of the finest street in Epping, with a perfect design and completely finished with superior standards, this contemporary home offers a convenient lifestyle and luxurious entertaining.

Crafted to the highest standards and fitted with quality inclusions throughout, this contemporary family residence with beautiful light-filled interiors and a flexible floorplan expresses its beauty in a practical and welcoming style.

Double brick and concrete slab construction underpins this architectural masterpiece and just completed you'll discover endless bespoke details.

The kitchen with fully integrated Miele appliances and it's all wrapped in exquisite marble. You also can find a beautiful marble feature wall in the living area.

Price : For Sale \$2,600,000
Land Size : 330.9 sqm
View : <https://www.uniland.com.au/sale/nsw/northern-suburbs/epping/residential/semi-detached/7934954>



Andy Lin
02 9869 7788

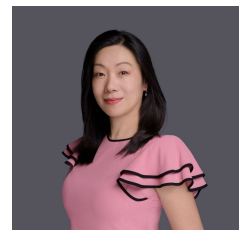

Julie Zhang
02 9869 7788

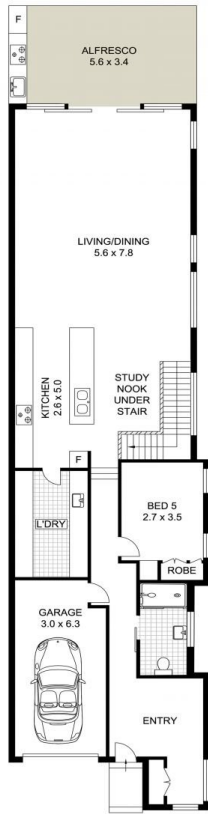

ENTRY LEVEL



UPPER LEVEL

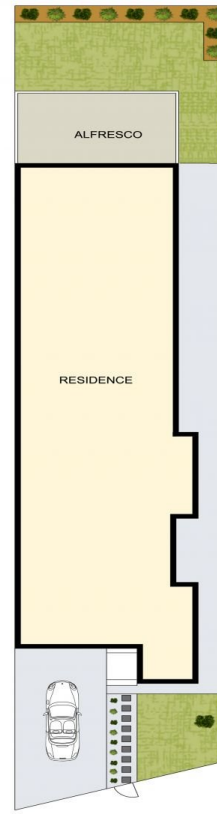

0 1 2 3 4 5m

Scale in metres. Indicative only. Dimensions are approximate.

DISCLAIMER: PLANS SHOWN ARE FOR MARKETING PURPOSES ONLY, ALL DIMENSIONS ARE APPROXIMATE AND NOT TO SCALE. THEY ARE SUBJECT TO ERRORS AND INACCURACIES AND NO LIABILITY WILL BE ACCEPTED. INTERESTED PARTIES SHOULD MAKE THEIR OWN INQUIRES.



30 Francis Street, Epping

