





1202/13 Halifax Street Macquarie Park NSW

2  2  1 

Located in the highly sought-after Macquarie Park locale, this spacious 2-bedroom apartment features an abundance of natural light and expansive parkland views, in an ultra-convenient location. Enjoy the luxury modern finishes, Miele appliances and ducted air conditioning throughout all spaces.

Just a short stroll to North Ryde Metro Station, with vibrant retail, dining and Coles, playgrounds and express City buses at your doorstep. Instant access to major roads M2, A38, A3 and minutes from Macquarie University.

Features:

- Generous open plan living and dining area adjoining a sunlit winter garden
- Sunny, north facing aspect in a peaceful leafy district
- Two spacious bedrooms with built in wardrobes and

Land Size : 102 sqm

View : <https://www.uniland.com.au/lease/nsw/north-ern-suburbs/macquarie-park/residential/apartment/7841437>



Sammi Sun
02 9869 7788



Linda Bo
02 9869 7788

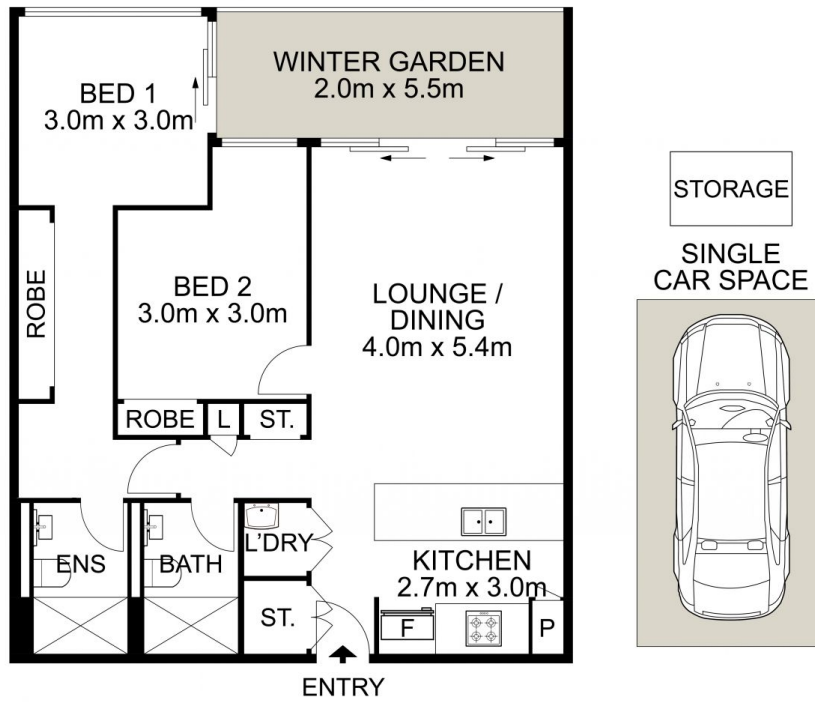

0 1 2 3 4 5
Scale in metres. Indicative only. Dimensions are approximate.



DISCLAIMER: PLANS SHOWN ARE FOR MARKETING PURPOSES ONLY. ALL DIMENSIONS ARE APPROXIMATE AND NOT TO SCALE. THEY ARE SUBJECT TO ERRORS AND INACCURACIES AND NO LIABILITY WILL BE ACCEPTED. INTERESTED PARTIES SHOULD MAKE THEIR OWN INQUIRES.

1202/13 Halifax Street, Macquarie Park

