



**125/421-473 Pacific Highway Artarmon NSW**

**2  2  1 **

**\*\* Phone Annie Zeng at 0416 822 502 prior to inspection for information on best parking for viewing.**

Set within a first class resort-style "Northview" complex, this beautiful and bright city view apartment on level 7 offers modern lifestyle with an open plan layout of indoor/outdoor living space, light filled interiors and quality fittings. Enjoying the city view balcony plus a versatile glass-wrapped sunroom or home office, this apartment is a special place to call home. With easy level access with transport at your door to Sydney CBD and Chatswood and short stroll to schools and Lane Cove or Artarmon shops and restaurants, in the catchment of Artarmon Public School and Chatswood High School, this is a must inspect.

\* Substantial open plan living and dining adjoins the sunroom/home office

**Building Size** : 131 sqm  
**View** : <https://www.uniland.com.au/sale/nsw/north-shore-lower/artarmon/residential/apartment/6980571>



**Annie Zeng**  
**02 9869 7788**



**Andy Lin**  
**02 9869 7788**

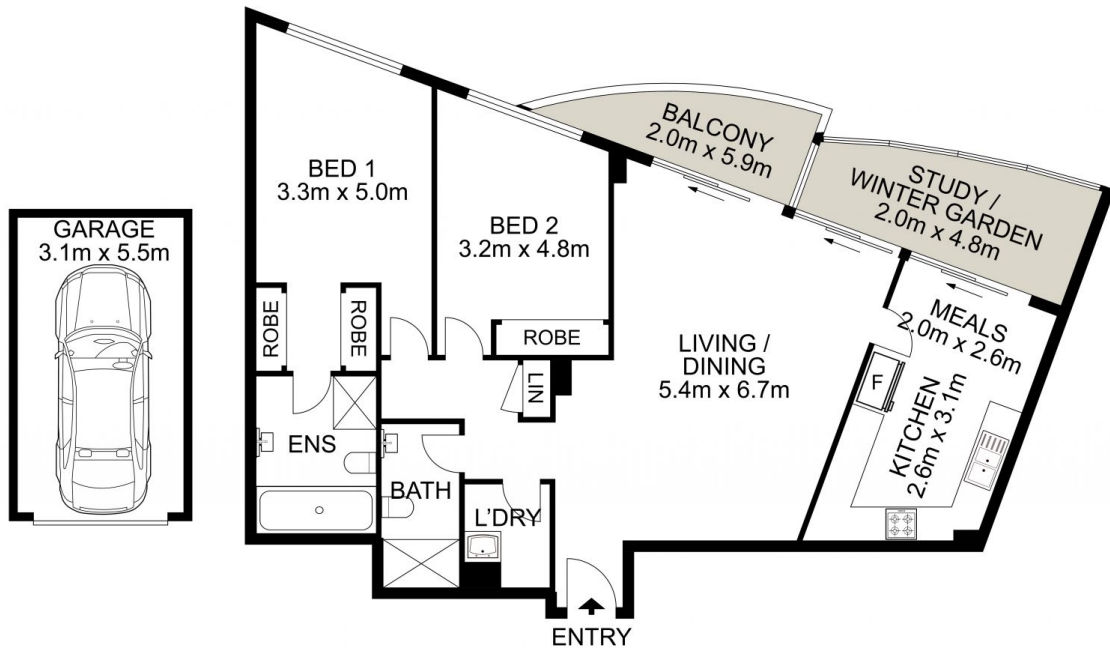

0 1 2 3 4 5  
Scale in metres. Indicative only. Dimensions are approximate.



**DISCLAIMER:** PLANS SHOWN ARE FOR MARKETING PURPOSES ONLY. ALL DIMENSIONS ARE APPROXIMATE AND NOT TO SCALE. THEY ARE SUBJECT TO ERRORS AND INACCURACIES AND NO LIABILITY WILL BE ACCEPTED. INTERESTED PARTIES SHOULD MAKE THEIR OWN INQUIRES.

125/421-473 Pacific Highway, Artarmon

