



11/9-13 Early Street Parramatta NSW

2  1  1 

Uniland Real Estate proudly represents this beautiful double brick two bedroom unit, situated on top floor of a secured complex with an easy stroll to Westfield. Stands out by its position, district views and versatile floor plan, this lovely home offers open plan, light filled interiors and generous sense of space. A truly ideal opportunity for first home buyer, investors, young families and working professionals looking for comfort and convenience.

Main features:

- * Large North Facing Light filled living & dining flows onto a L shaped balcony
- * Two good sized bedrooms one with built in wardrobes
- * Modern kitchen with gas cooking, range hood & ample storage
- * Contemporary bathroom with bathtub
- * Beautiful laminate floor, freshly painted, new blinds and

Price : \$ 552,500
Land Size : 108 sqm
View : <https://www.uniland.com.au/sale/nsw/parramatta/parramatta/residential/apartment/6964337>



Annie Zeng
02 9869 7788



Andy Lin
02 9869 7788

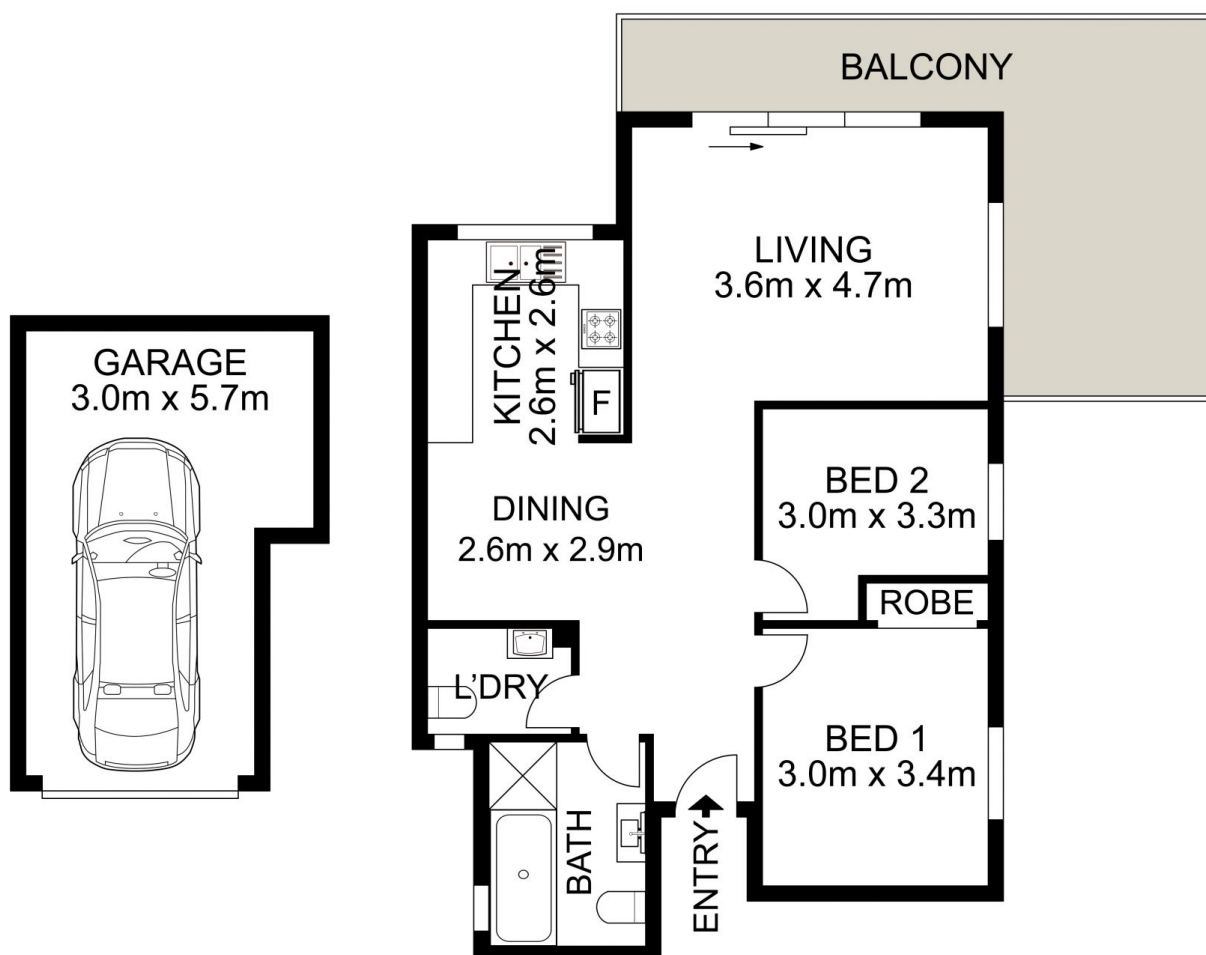

11/9-14 Early Street, Parramatta

DISCLAIMER:

PLANS SHOWN ARE FOR MARKETING PURPOSES ONLY, ALL DIMENSIONS ARE APPROXIMATE AND NOT TO SCALE. THEY ARE SUBJECT TO ERRORS AND INACCURACIES AND NO LIABILITY WILL BE ACCEPTED. INTERESTED PARTIES SHOULD MAKE THEIR OWN INQUIRES.

