



1002/395 Princes Highway Rockdale NSW

1  1  1 

Situated on the top-floor of the well-designed building in the heart of Rockdale, with spacious interior connectivity and illuminated by a bright north aspect, this stylish one bedroom PLUS large study apartment is ideal for first home buyers, professionals and astute investors.

Price : \$ 600,000
Land Size : 79 sqm
View : <https://www.uniland.com.au/sale/nsw/st-geo/rge/rockdale/residential/unit/6676887>

Main Features:

- *Both Main bedroom and Balcony have a brilliant city view
- *Desirable north aspect full of natural light
- *Spacious open plan living & dining area flowing out to the large balcony
- *Gourmet gas kitchen with quality appliances
- *Oversized bedroom with built in robes
- *Large study/versatile room
- *Modern Bathroom with floor to ceiling tiled



Andy Lin
02 9869 7788



Kris Yu
02 9869 7788

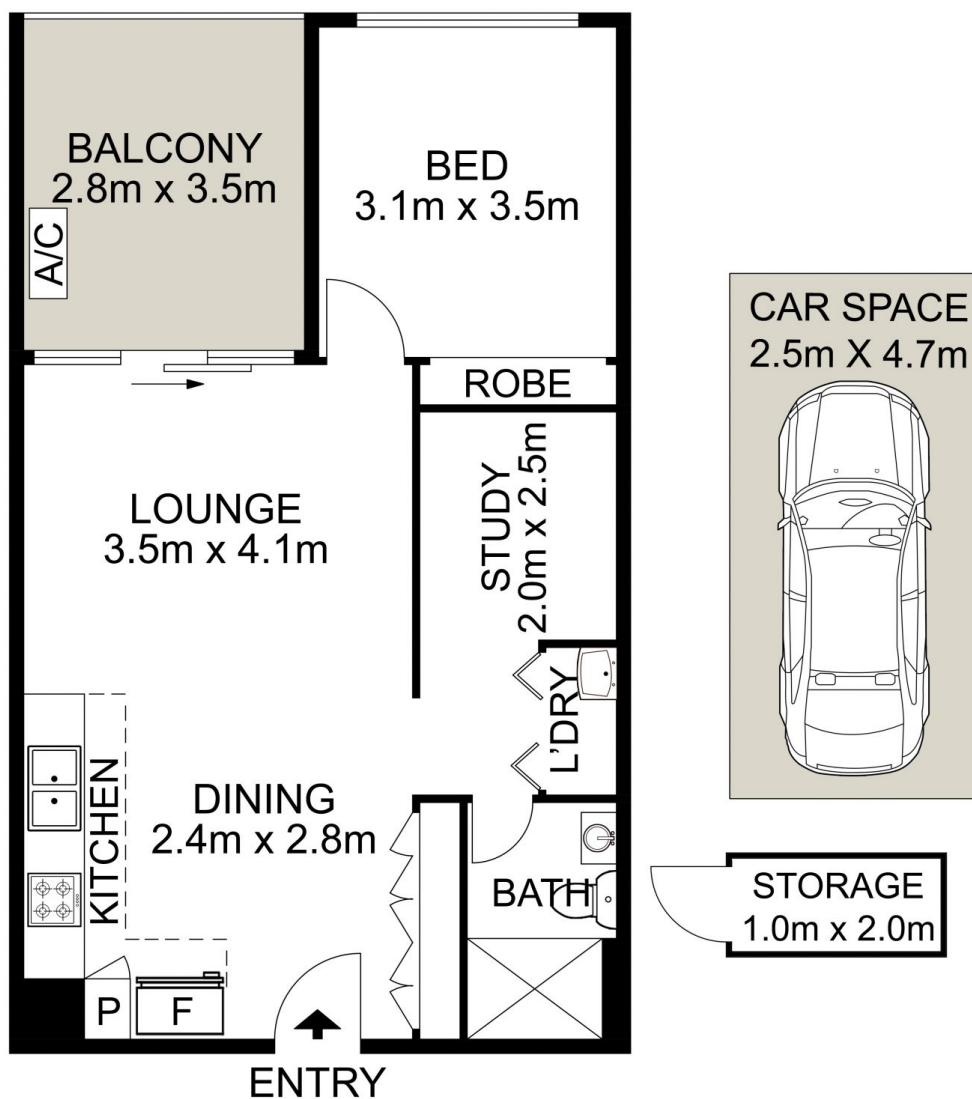

1002/395 Princes Highway, Rockdale

DISCLAIMER:

PLANS SHOWN ARE FOR MARKETING PURPOSES ONLY, ALL DIMENSIONS ARE APPROXIMATE AND NOT TO SCALE. THEY ARE SUBJECT TO ERRORS AND INACCURACIES AND NO LIABILITY WILL BE ACCEPTED. INTERESTED PARTIES SHOULD MAKE THEIR OWN INQUIRES.

