



48 Farmland Drive Schofields NSW

4  2  1 

Private Inspections available by appointments 7 days a week!

Situated in a highly sought-after pocket in Schofields, just minutes to Schofields train station, Tallawong metro station, buses, local shopping centre and schools, this impressive four-bedroom house with flawless quality throughout offers a perfect opportunity for the first home buyers, growing families or astute investors.

The contemporary and easy maintenance home features north facing backyard, sun-drenched and spacious interiors with more rooms and abundant living space to suit a big family.

Main Features:

Price : \$ 950,000
Land Size : 224 sqm
View : <https://www.uniland.com.au/sale/nsw/western-sydney/schofields/residential/house/6593301>



Andy Lin
02 9869 7788



Lisa Zhang
02 9869 7788

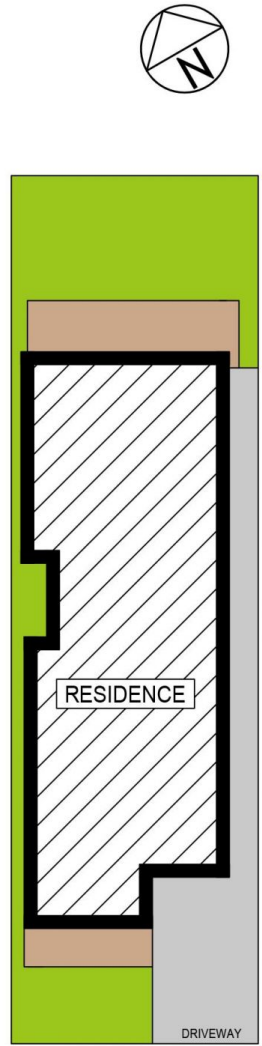
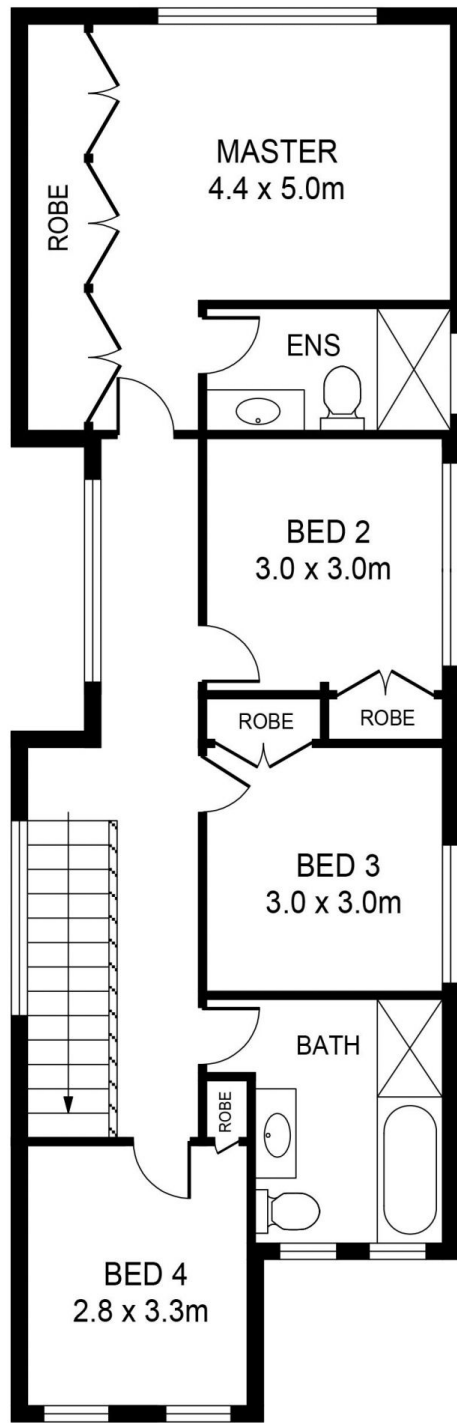
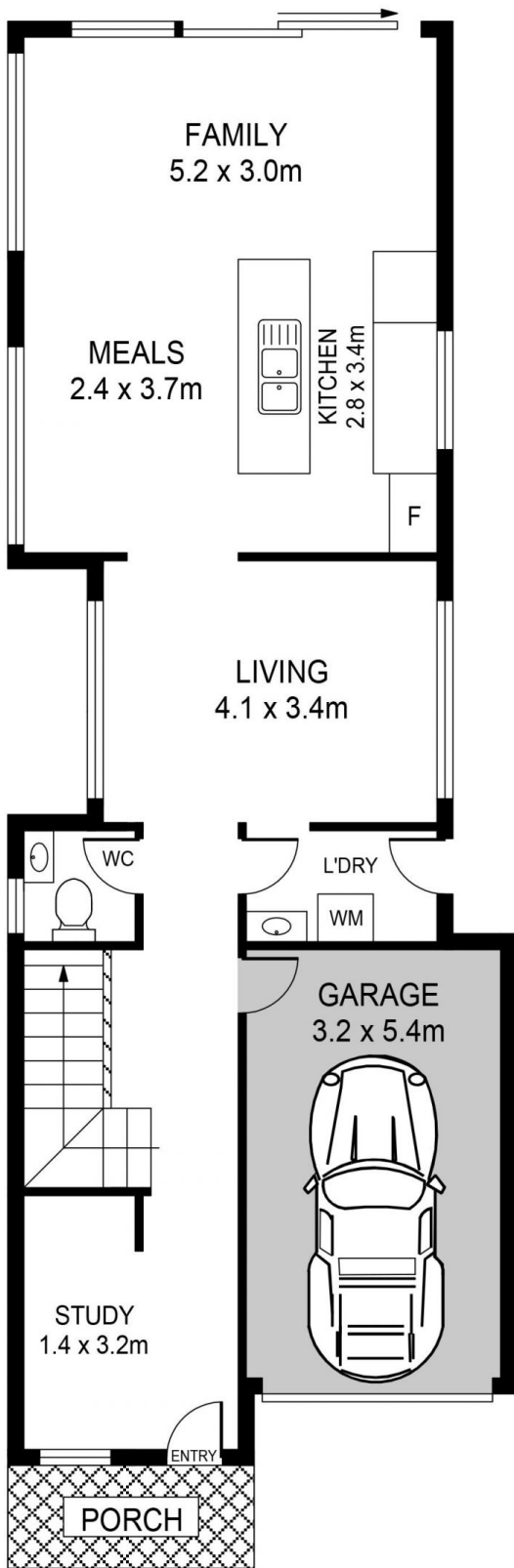

48 FARMLANDS DRIVE, SCHOFIELDS

DISCLAIMER:

PLANS SHOWN ARE FOR MARKETING PURPOSES ONLY, ALL DIMENSIONS ARE APPROXIMATE AND NOT TO SCALE. THEY ARE SUBJECT TO ERRORS AND INACCURACIES AND NO LIABILITY WILL BE ACCEPTED. INTERESTED PARTIES SHOULD MAKE THEIR OWN INQUIRIES.

